

**ADDITION TO MEYO RESIDENCE**

119 EAST DUDLEY AVENUE  
TOWN OF WESTFIELD  
UNION COUNTY  
NEW JERSEY, 07090

JOB NO.: 03-130



ETHAN MARSH  
534 HANFORD PLACE  
WESTFIELD, NJ 07090  
(908) 209-9019  
MAIL@ETHANMARSHDESIGN.COM  
WWW.ETHANMARSHDESIGN.COM

**LIST OF DRAWINGS**

- A-1 - DEMOLITION PLANS & EXISTING ELEVATIONS
- A-2 - ZONING ANALYSIS, PARTITION LEGEND, PLOT PLAN & BASEMENT PLAN
- A-3 - 1st & 2nd FLOOR PLANS
- A-4 - ATTIC & ROOF PLANS
- A-5 - EAST & NORTH ELEVATIONS
- A-6 - WEST & SOUTH ELEVATIONS

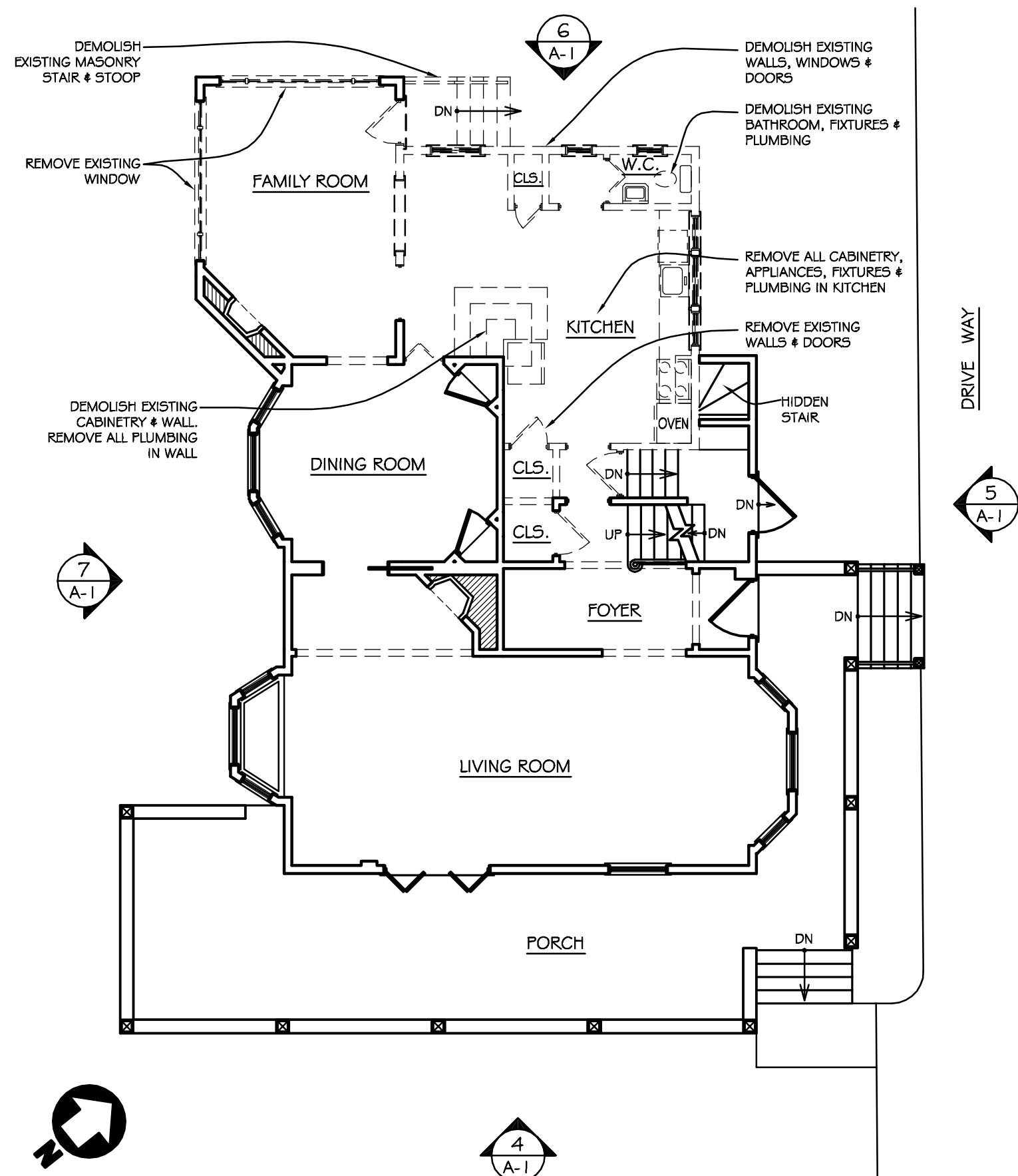

**1** 1st FLOOR DEMOLITION PLAN  
1/8" = 1'-0"

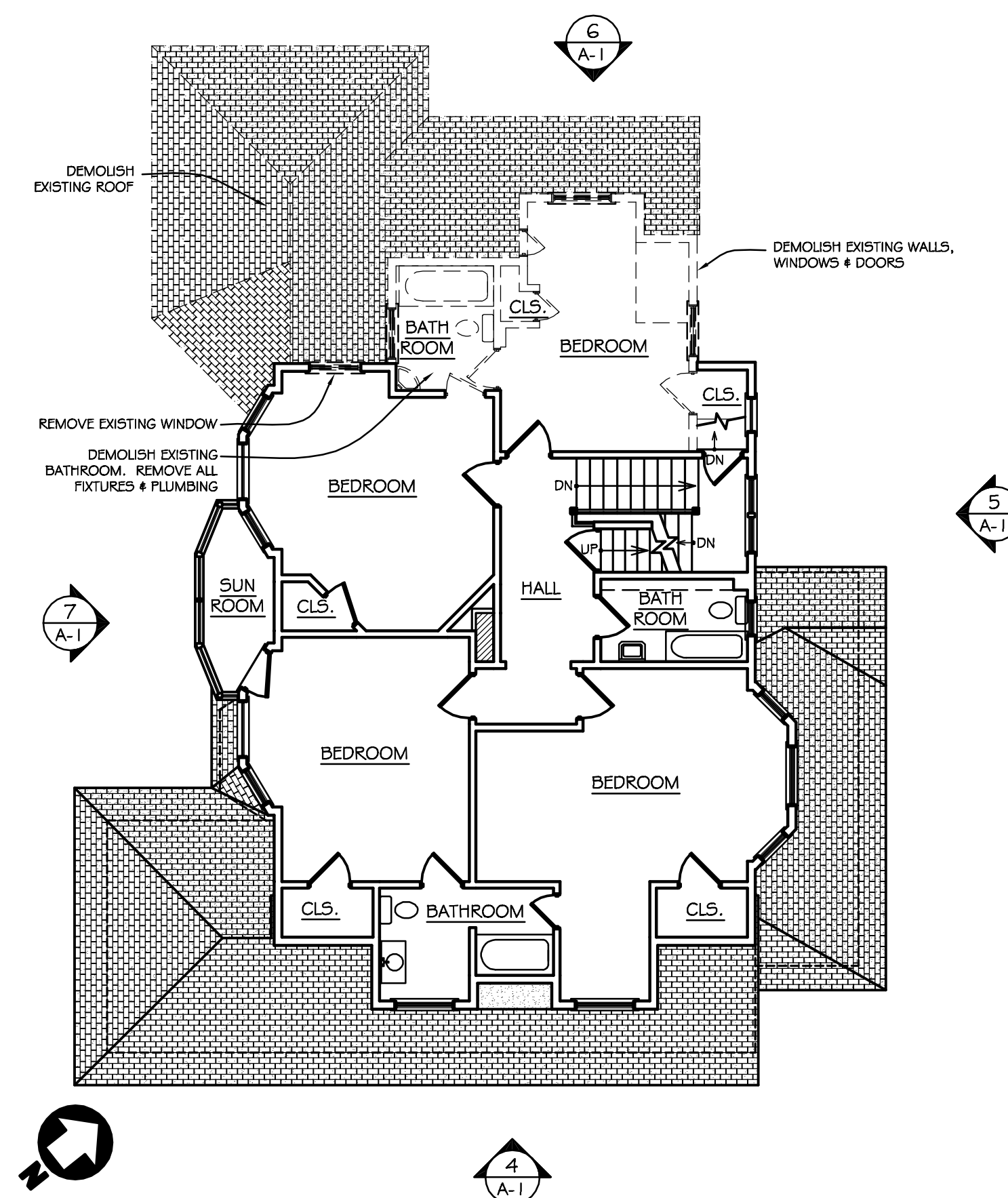

**2** 2nd FLOOR DEMOLITION PLAN  
1/8" = 1'-0"

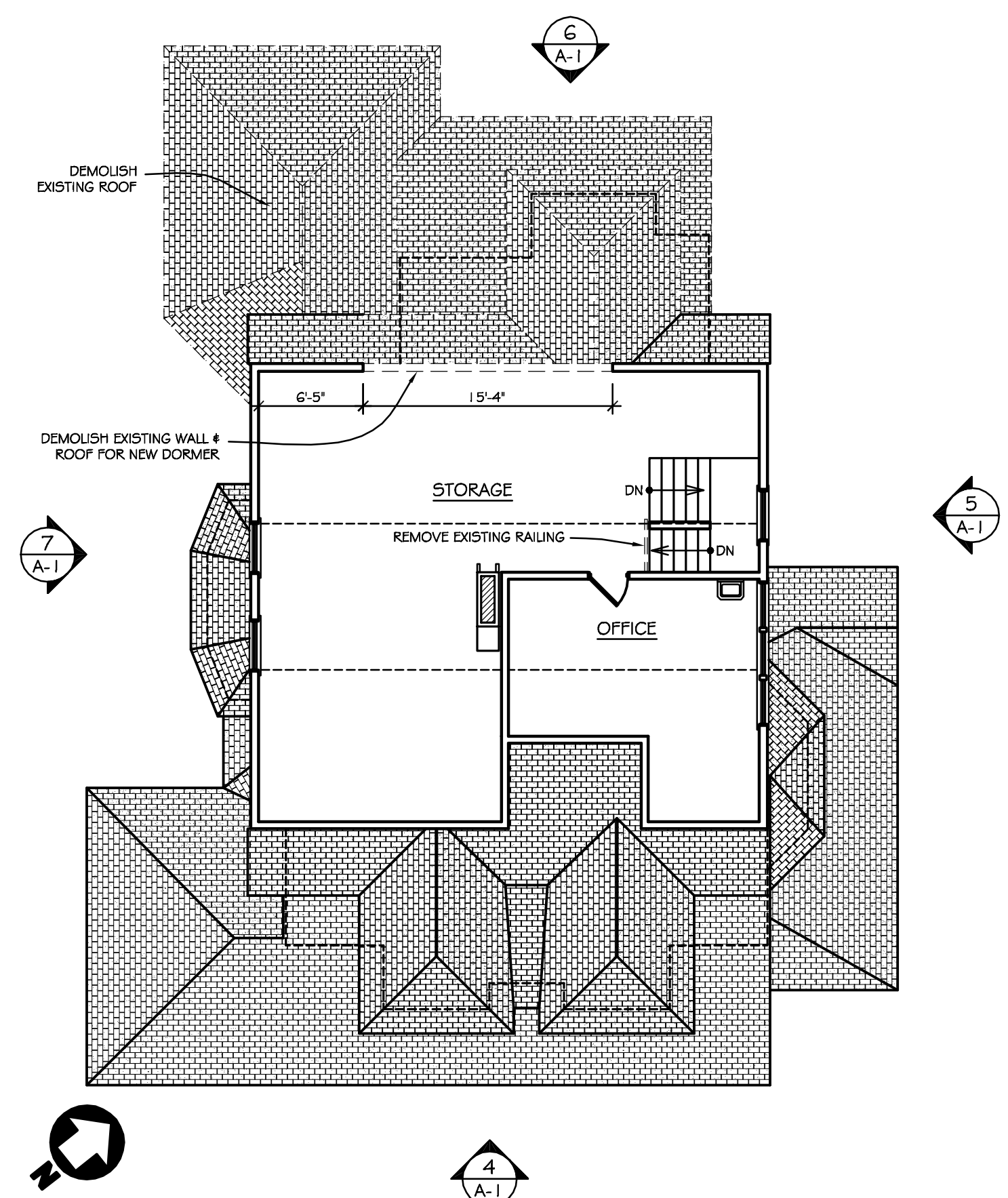

**3** ATTIC DEMOLITION PLAN  
1/8" = 1'-0"



**4** EXISTING EAST ELEVATION  
1/8" = 1'-0"



**5** EXISTING NORTH ELEVATION  
1/8" = 1'-0"



**6** EXISTING WEST ELEVATION  
1/8" = 1'-0"



**7** EXISTING SOUTH ELEVATION  
1/8" = 1'-0"

THESE DRAWINGS ARE FOR REVIEW, DESIGN, AND SCOPE DESCRIPTION ONLY. NO REPRESENTATION IS MADE TO THE ACCURACY OF THE DRAWINGS WITH RESPECT TO THE EXISTING DIMENSIONS OR CONDITIONS. ALL CONSULTANTS AND CONTRACTORS MUST VERIFY ANY AND ALL DIMENSIONS AND CONDITIONS WHICH ARE CRITICAL TO THEIR WORK.

NO.	DATE	ISSUED FOR
7/6/04	CD-001	BID SET

**DEMOLITION PLANS & EXISTING ELEVATIONS**

**A-1** SCALE: 1/8" = 1'-0"  
DATE DRAWN: 6/28/0  
NO. 1 OF 6 DWGS.  
03-010 - MEYO RESIDENCE